

# SAB/SVB/NAB

(Cylinder valve)

## Air operated 2 port valve

■ For water, air, gas, low vacuum, steam

### Overview

**In addition to water, air, gas, low vacuum and steam, high viscosity fluids and powder mixed fluids are also available.**

Using the external pilot air, this air operated cylinder valve is driven with the cylinder. Air operated type SAB, solenoid valve mounted type SVB, compact type NAB and manifold GNAB Series are available to meet needs of controlling various fluids.

### Features

#### Wide variation

Rc1/4 to 80 flange are available in accordance with port size.

#### Available in flammable environment

3 actuations

3 types: NC (normally closed), NO (normally open) and double acting are available.

**Cylinder driven with external pilot air ensures certain operations.**

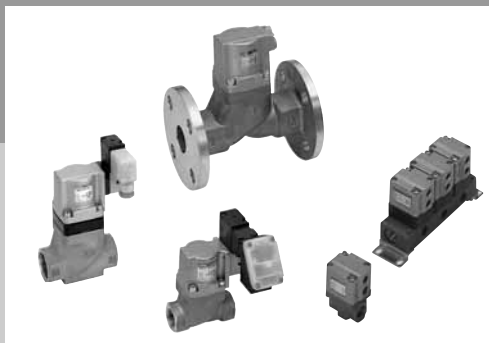

## CONTENTS

Series variation	438
▲ Safety precautions	440
● Product introduction	444
Air operated type (port size Rc1/4 to Rc2, 32 to 80 flange)	
● Water, liquid	SAB*W 446
● Air	SAB*A 450
● Low vacuum	SAB*V 454
● Steam, water, air	SAB*S 458
Solenoid valve mounted type (port size Rc1/4 to Rc2, 32 to 80 flange)	
● Water, liquid	SVB*W 462
● Air	SVB*A 470
● Low vacuum	SVB*V 474
● Steam, water, air	SVB*S 478
Compact air operated type (port size Rc1/4, Rc3/8)	
Discrete	
● Air, gas, water	NAB* 484
● Low vacuum, air, water	NAB*V 486
Manifold	
● Air, gas, water	GNAB* 488
● Low vacuum, air, water	GNAB*V 492
📄 CAD	Electronic Catalog file list 496

▲ Always read the precautions in the Introduction and page 440 before starting use.

HNB/G

USB/G

FAB/G

FGB/G

FVB

FWB/G

FHB

FLB

AB

AG

AP/  
AD

APK/  
ADK

For  
dry air

Explosion  
proof

HVB/  
HVL

**SAB/  
SVB**

NP/NAP/  
NVP

CHB/G

MXB/G

Other G.P.  
systems

PD/FAD/  
PJ

CVE/  
CVSE

CPE/  
CPD

Medical  
analysis

Custom  
order

Cylinder valve  
Air operated 2 port valve